

JH Chip type, High Ripple Current Series



Solvent Proof
WV ≤ 100V



- High Ripple current Compared with JC series
- Designed for surface mounting on high density PC board
- Applicable to automatic insertion machine using carrier tape
- Complied to the RoHS directive

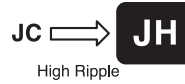

Item	Characteristics																																
Operating temperature range	WV ≤ 100 : -55 ~ +105°C WV ≥ 160 : -40 ~ +105°C																																
Leakage current max.	WV ≤ 100 I = 0.01CV or 3μA whichever is greater (after 2 minutes) WV ≥ 160 I = 0.04CV + 100μA (after 1 minutes)																																
Capacitance tolerance	±20% at 120Hz, 20°C																																
Dissipation factor max. (at 120Hz, 20°C)	<table border="1"> <tr> <td>WV</td> <td>6.3</td> <td>10</td> <td>16</td> <td>25</td> <td>35</td> <td>50</td> <td>63</td> <td>100</td> <td>160</td> <td>200</td> <td>250</td> <td>400</td> <td>450</td> </tr> <tr> <td>tanδ</td> <td>0.28</td> <td>0.24</td> <td>0.20</td> <td>0.16</td> <td>0.13</td> <td>0.12</td> <td>0.10</td> <td>0.10</td> <td>0.15</td> <td>0.15</td> <td>0.15</td> <td>0.20</td> <td>0.20</td> </tr> </table>	WV	6.3	10	16	25	35	50	63	100	160	200	250	400	450	tanδ	0.28	0.24	0.20	0.16	0.13	0.12	0.10	0.10	0.15	0.15	0.15	0.20	0.20				
WV	6.3	10	16	25	35	50	63	100	160	200	250	400	450																				
tanδ	0.28	0.24	0.20	0.16	0.13	0.12	0.10	0.10	0.15	0.15	0.15	0.20	0.20																				
Low temperature characteristics (Impedance ratio at 120Hz)	<table border="1"> <tr> <td>WV</td> <td>6.3</td> <td>10</td> <td>16</td> <td>25 ~ 50</td> <td>63 ~ 100</td> <td>160 ~ 250</td> <td>400 ~ 450</td> </tr> <tr> <td>Z-25°C/Z+20°C</td> <td>3</td> <td>3</td> <td>2</td> <td>2</td> <td>3</td> <td>3</td> <td>6</td> </tr> <tr> <td>Z-40°C/Z+20°C</td> <td>-</td> <td>-</td> <td>-</td> <td>-</td> <td>-</td> <td>6</td> <td>10</td> </tr> <tr> <td>Z-55°C/Z+20°C</td> <td>8</td> <td>5</td> <td>4</td> <td>3</td> <td>4</td> <td>-</td> <td>-</td> </tr> </table>	WV	6.3	10	16	25 ~ 50	63 ~ 100	160 ~ 250	400 ~ 450	Z-25°C/Z+20°C	3	3	2	2	3	3	6	Z-40°C/Z+20°C	-	-	-	-	-	6	10	Z-55°C/Z+20°C	8	5	4	3	4	-	-
WV	6.3	10	16	25 ~ 50	63 ~ 100	160 ~ 250	400 ~ 450																										
Z-25°C/Z+20°C	3	3	2	2	3	3	6																										
Z-40°C/Z+20°C	-	-	-	-	-	6	10																										
Z-55°C/Z+20°C	8	5	4	3	4	-	-																										
Load life (after application of the rated voltage for 2000 hours at 105°C)	<table border="1"> <tr> <td>Leakage current</td> <td>Less than specified value</td> </tr> <tr> <td>Capacitance change</td> <td>Within ±20% of initial value</td> </tr> <tr> <td>tanδ</td> <td>Less than 200% of specified value</td> </tr> </table>	Leakage current	Less than specified value	Capacitance change	Within ±20% of initial value	tanδ	Less than 200% of specified value																										
Leakage current	Less than specified value																																
Capacitance change	Within ±20% of initial value																																
tanδ	Less than 200% of specified value																																
Shelf life (at 105°C)	After 1000 hours no load test, leakage current, capacitance and tanδ are same as load life value. The measurement shall be performed at 20°C by the KS C IEC 60384 - 4																																
Resistance to soldering heat	<p>The following specifications shall be satisfied when the capacitors are restored to 20°C after exposing them at 250°C for 10 seconds.</p> <table border="1"> <tr> <td>Leakage current</td> <td>Less than specified value</td> </tr> <tr> <td>Capacitance change</td> <td>Within ±10% of initial value</td> </tr> <tr> <td>tanδ</td> <td>Less than specified value</td> </tr> </table>	Leakage current	Less than specified value	Capacitance change	Within ±10% of initial value	tanδ	Less than specified value																										
Leakage current	Less than specified value																																
Capacitance change	Within ±10% of initial value																																
tanδ	Less than specified value																																

CHIP TYPES

● DRAWING -Series code of JH is "G"

Unit : mm

(∅6.3, ∅8×6.2)

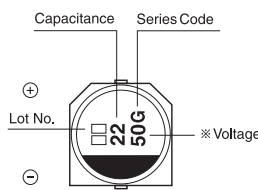

※ Voltage mark for 6.3V is 「6」

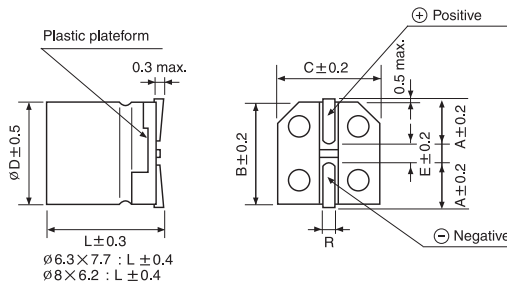

∅D×L	A	B	C	E	R
6.3×5.8	2.4	6.6	6.6	2.2	0.5~0.8
6.3×7.7	2.4	6.6	6.6	2.2	0.5~0.8
8×6.2	3.3	8.3	8.3	2.3	0.5~0.8
8×10	2.9	8.3	8.3	3.1	0.8~1.1
10×10	3.2	10.3	10.3	4.5	0.8~1.1
12.5×13.5	4.6	12.8	12.8	4.5	0.8~1.4

(∅8×10, ∅10×10)

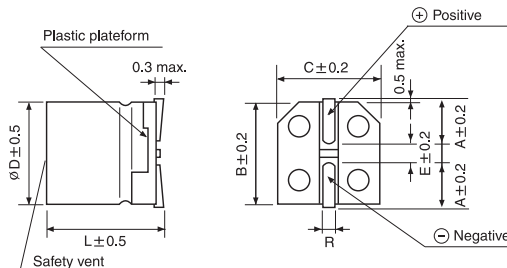
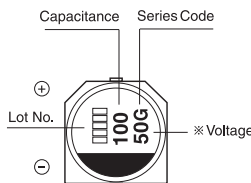

(∅12.5)

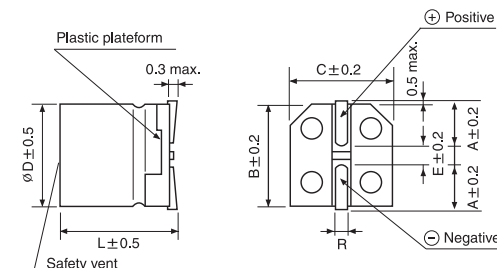
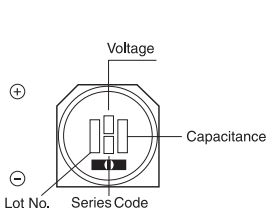

SURFACE MOUNT ALUMINUM ELECTROLYTIC CAPACITORS

JH series

● DIMENSIONS & MAXIMUM PERMISSIBLE RIPPLE CURRENT

μF \diagdown WV	6.3		10		16		25		35	
10										
22							6.3×5.8	57	6.3×5.8	63
33					6.3×5.8	60	6.3×5.8	72	8×6.2	114
47			6.3×5.8	69	6.3×5.8	75	8×6.2	120	8×10	186
100	6.3×5.8	90	6.3×5.8	90	8×10	222	8×10	270	10×10	456
220	8×10	242	8×10	260	10×10	495	10×10	525	10×10	675
330	8×10	432	10×10	477	10×10	660	10×10	558	12.5×13.5	750
470	10×10	510	10×10	527	10×10	735	10×10	675	12.5×13.5	900
680	10×10	612	10×10	588	12.5×13.5	750	12.5×13.5	750		
1000	10×10	743	10×10	825	12.5×13.5	900				
1500	10×10	840	12.5×13.5	975						
2200	12.5×13.5	1095								

Ripple current (mA rms) at 105°C, 120Hz
 Case size $\varnothing D \times L$ (mm)

μF \diagdown WV	50		63		100	
10	6.3×5.8	45	8×6.2	48		
22	8×6.2	100	8×10	90	8×10	135
33	8×10	200	8×10	165	10×10	180
47	10×10	270	10×10	195	12.5×13.5	375
68	10×10	315	10×10	240	12.5×13.5	450
100	10×10	465	12.5×13.5	405		
220	12.5×13.5	720				

μF \diagdown WV	160		200		250		400		450	
3.3					10×10	45	12.5×13.5	45	12.5×13.5	60
4.7			10×10	65	12.5×13.5	95				
10	10×10	65	12.5×13.5	110						
22	12.5×13.5	125	12.5×13.5	125						
33	12.5×13.5	140								
47										
68										
100										

Ripple current (mA rms) at 105°C, 120Hz
 Case size $\varnothing D \times L$ (mm)

● FREQUENCY COEFFICIENT OF PERMISSIBLE RIPPLE CURRENT

Frequency	50Hz	120Hz	300Hz	1kHz	10kHz \leq
Coefficient	0.70	1.00	1.17	1.36	1.50